

# Additional Information

## Connector configuration for mp6

### mp6 – Flex connector

The mp6 pump can be connected via a standard electrical connector manufactured by Molex. The layout of the connector and pin assignment of the mp6 can be found in the following.

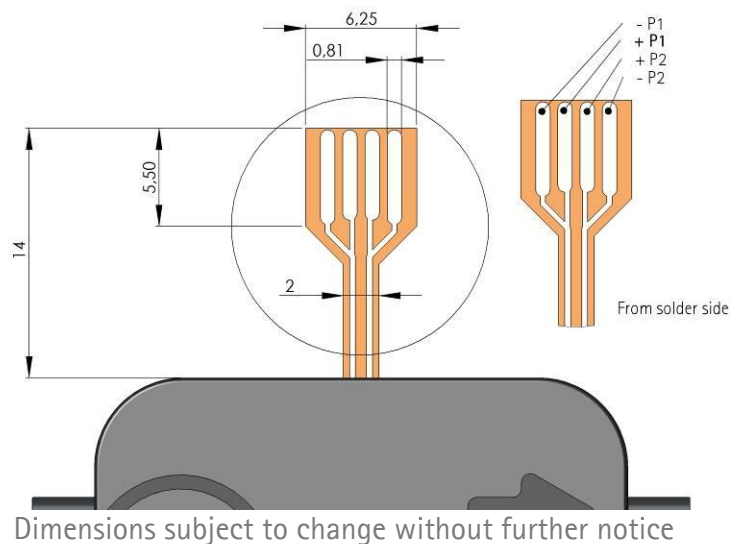

Dimensions subject to change without further notice

The recommended connector is a 4 pin 1.25 mm pitch FCC connector manufactured by Molex, part number 39 53 2045. The connector is available in different versions to fit various applications. Reference drawings and further specifications are available under [www.molex.com](http://www.molex.com).

The recommended maximum wire length between controller and the pump is 1 m. The customer has to assure that the assembly of pump, controller and electrical connection complies with the EMC regulations and electrical safety in the specific field of application.

To connect the mp6 and molex, refer to the three figures in the right column. Orientate both components as indicated on the first picture, the mp6 with the metallic contacts down. Then insert the mp6 flex into the molex connector. Close the molex connector to complete the interconnection between both components.

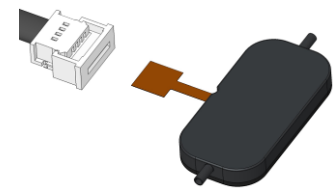

Connecting the mp6 – step 1

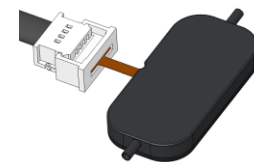

Connecting the mp6 – step 2

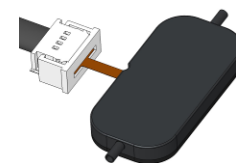

Connecting the mp6 – step 3



## Molex connector

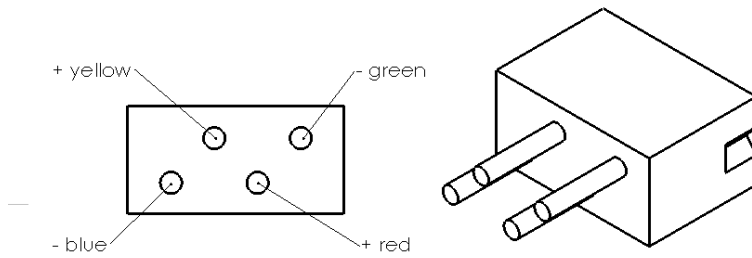

The cable pairs blue/yellow and green/red are connected to the same piezo actuator.

## Binder connector (mp-x)

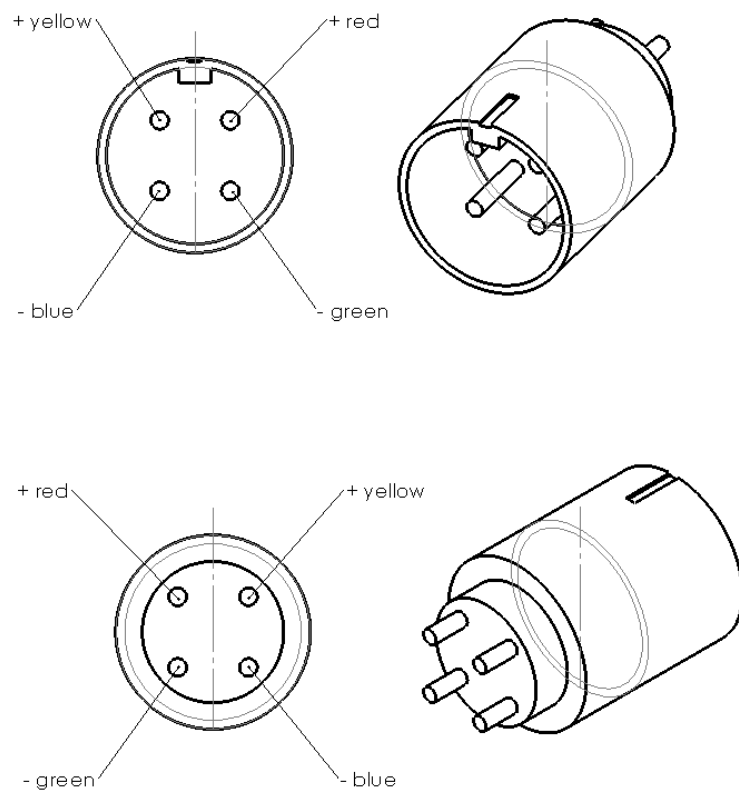

The cable pairs blue/yellow and green/red are connected to the same piezo actuator.

All values are approximate and no guarantee of specific technical properties.

Changes in the course of technical progress are possible without notice.



**Contact Data:**

Bartels Mikrotechnik GmbH  
Konrad-Adenauer-Allee 11  
44263 Dortmund Germany  
[www.bartels-mikrotechnik.de](http://www.bartels-mikrotechnik.de)  
[info@bartels-mikrotechnik.de](mailto:info@bartels-mikrotechnik.de)  
Tel: +49-231-47730-500  
Fax: +49-231-47730-501

**Visit our Website**

[www.bartels-mikrotechnik.de/downloads](http://www.bartels-mikrotechnik.de/downloads)

**for further information on applications.**

**Tutorials and helpful answers to frequently asked questions can be found in our FAQ**

[www.bartels-mikrotechnik.de/en/faq-english/](http://www.bartels-mikrotechnik.de/en/faq-english/)

**or on our YouTube channel**

<https://www.youtube.com/user/BartelsMikrotechnik>

**Find us on Social Media:**

